

60.00 mm

80.00 mm

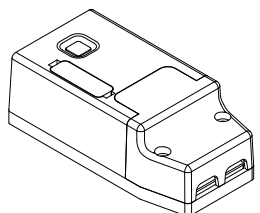

Instructions

Wireless One/Two way Controller

Product Description

Wireless One/Two way controller can be used with wireless kinetic energy switch to control electrical appliances.

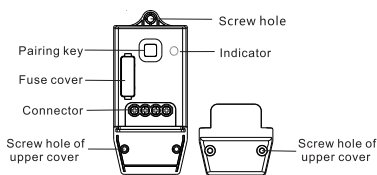

Product Parameters

Input Voltage: AC100~240V 50/60Hz
 Rated Power: Max5A LED600W (One-way Controller)
 Max5A*2 LED600W*2 (Two-way Controller)
 Max10A LED1000W (10A One-way Controller)

Wireless Communication: RF 433MHz
 Distance: 80m (outdoor) 25m (indoor)
 Operating temperature: -25~55°C
 Sensitivity: -110dBm
 Dimension: L70*W44*H29mm
 Storage capacity: Up to 10 switches can be paired
 Execution standards: EN60669-1:1999+A1:2002+A2:2008

Note : The effective distance data is measured by laboratory and will vary in actual use due to environmental changes.

Installation

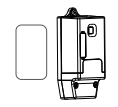
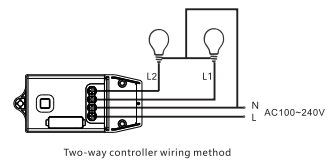
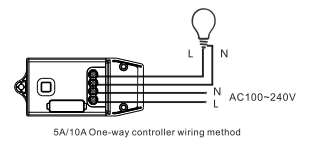

Fixing method 1: Use the double-sided adhesive tape inside the package to paste on a clean surface

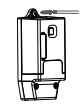

Fixing method 2: Use self-tapping screws to lock in expansion screw in the wall surface

Combination

The controller and the kinetic energy switch can be freely combined by pairing to form the one- to-multi and multi-to-one control mode.

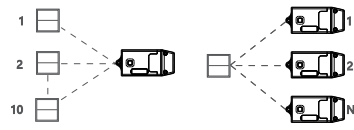

Multi control one (Maximum 10 switch keys control one controller) One control multi (One switch key can control multiple controllers, no limits)

Ordinary Paring Method

1. Connect the controller's input to the power supply, press the controller "pairing key" around 3 seconds, release when indicator light flash slowly (flash 1 time per second).
2. Press the selected kinetic energy switch once (Do not press several times continuously), then indicator light is off, means the paring is successful.
3. If need to pair with multiple switches, repeat the above procedure. Please note one controller can be paired with 10 switch keys maximum. Double-click the function button to switch the channel (Only supported by 603 series Two-way controller)
4. After the paring is successful, you can press the kinetic switch to control the controller. Without loads, the indicator light is on, means the controller is working, vice versa.

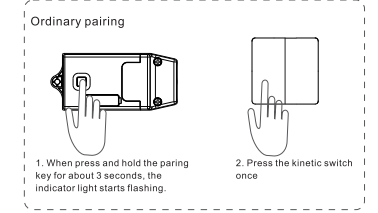

Directional pairing (not commonly used)

- In order to meet the user's usage habit of switch and to ensure the synchronization of one control multi mode, we define the directional pairing mode. Directional paring only support rocker type switch and 2 keys or 6 keys push button switch.
1. Connect the controller's input with the power supply, press the controller "pairing key" around 3 seconds, release when indicator light flash (flash 1 time per second).
 2. For rocker type switch, quick press the switch key twice (within 0.5 second). For push button switch, quick press any key 4 times (within 1second), then the indicator light goes off, means the paring is successful.
 3. After paring is successful, for rocker type switch, pressing upside button is OFF, pressing downside button is ON. For push button switch, left and right key as a group, pressing the left key is OFF and pressing the right key is ON, long pressing the left key is dimming, long pressing right key brighten the lights.

Directional Pairing of Rocker Switch

1. Press and hold for about 3 seconds, the indicator light starts flashing.
2. Quickly press the upside and downside of switch once respectively (in 0.5 seconds)
3. After successful pairing, press downside to ON and press upside to OFF

Push Button Switch Directional Pairing (Only supports double or six keys)

1. Press and hold for about 3 seconds, the indicator light starts flashing
2. Quickly press any key four times (within 1seconds)
3. After pairing is successful, press the left button to turn off lamps, and the right one to turn on lamps.

Clear Pairing

1. If you need to unmatch the kinetic energy switch and the controller, press and hold the controller "pairing key" for about 12 seconds. The indicator flashes - keeps lit - until off. Double-click the function button to switch the channel and clear pairing information (Only supported by 603 series Two-way controller) At that time, all the previous paired information of kinetic switch with this controller is cleared. If need to use the controller again, please follow the instructions to pair again.

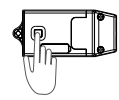

Press and hold for about 12 seconds, the indicator flashes until it is lit, and finally it goes out.

Bridging Function

- To increase the distance of control and the ability to penetrate the wall, we have defined the Bridging Mode function. The bridging mode is recommended to use when the distance is too long between switch and controller in one control multi mode.
1. First pair the switch with all controllers . (Using Directional Paring)
 2. As shown in the figure, select controller 1 that is closest to the switch and open the controller Bridging Mode .
 3. Press and hold the "Pairing Key" on the controller 1 for about 7 seconds. The indicator light flashes from slowly to quickly. Release the button. Wait a few seconds, the controller's indicator flashes once every two seconds, bridging mode is turned on.

4. After the bridging mode is on, the controller with activated bridging function will forward and enhance the signal in order to increase the control distance and the ability to penetrate the wall.

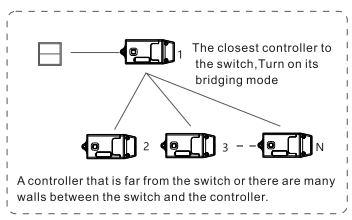

Troubleshooting

1. After the controller is power on, press the pairing button, but indicator light is still off.
Troubleshooting method: If you use a load that exceeds the rated current or it is short circuit, the fuse may has blown. Please exclude the short-circuitt fault, open the cover and replace with same fuses of the same specifications.
2. When the load is LED light, the LED lamp has weak glow in the off state.
Troubleshooting method: Please follow the L (live line) and N (neutral line) symbols on the controller to correctly wire the neutral and live line at the input part.

Certificate / Inspected